



ESTD. 1942

# H. D. JAIN COLLEGE

(A Constituent Unit of Veer Kunwar Singh University, Ara)

Ara, (Bihar), India Pin - 802301



## 3D TOP VIEW MASTER PLAN



Drawn & Design By :

AYAN ENTERPRISES, Patna

Mobile No. : +91 9386034271, +91 9097438464

Total Campus Area : 22.18 Acres  
Total Buildup Area : 26304.00 Sq.mtr





ESTD. 1942

# H. D. JAIN COLLEGE

(A Constituent Unit of Veer Kunwar Singh University, Ara)

Ara, (Bihar), India Pin - 802301



## 3D PERSPECTIVE VIEW MASTER PLAN



**Total Campus Area : 22.18 Acres**  
**Total Buildup Area : 26304.00 Sq.mtr**

Drawn & Design By :  
AYAN ENTERPRISES, Patna  
Mobile No. : +91 9386034271, +91 9097438464





ESTD. 1942

# H. D. JAIN COLLEGE

(A Constituent Unit of Veer Kunwar Singh University, Ara)

Ara, (Bihar), India Pin - 802301

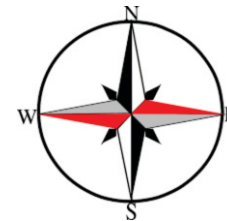

## 3D & 2D VIEW MASTER PLAN

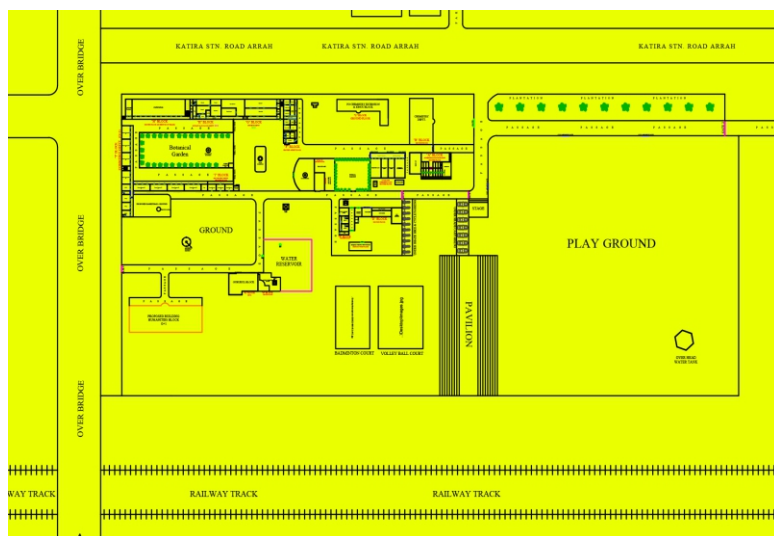

## DIRECTION MAP

### "A" Block

#### Administrative Building

**Ground Floor**  
NCC Department  
Admission Counter

### "B" Block

**Ground Floor**  
Chemistry Department

### "C" Block

**Ground Floor**  
Chemistry Lab 1  
Chemistry Lab 2  
Chemistry Lab 3  
Chemistry Classroom

### "D" Block

**Ground Floor**  
Old Office Building  
Post Office  
Gymnasium  
Athlete Council  
Toilet  
Kalpana Chawla Girl's Hostel

### "E" Block

**Ground Floor**  
Boy's Common Room  
IQAC Room With Toilet  
NAAC Room With Toilet  
NSS Room

### "F" Block

**Ground Floor**  
Office  
Principal Chamber  
Toilet  
Xerox Counter  
Library Office 1  
Library Office 2  
Library Room 1  
Library Room 2  
Library Store Room  
Library Room 3  
Sanskrit-Prakrit Department  
Philosophy Classroom  
PE-EG Office  
Examination Office 1  
Examination Office 2  
Examination Office 3  
Psychology Department  
Toilet

Psychology Office Cum Classroom  
Psychology Classroom

### "F" Block

**First Floor**  
Central Bank of India  
Bank Strong Room 1  
Bank Strong Room 2  
Library Room 4  
Library Room 5

### "G" Block

#### Physics Department

**Ground Floor**  
Physics ISC Lab  
Physics Teacher's Room  
Proctor Room  
Physics Lab 1  
Toilet  
Room  
Physics Classroom 1  
Physics Classroom 2  
Seating Area for Teacher's

### "G" Block

**First Floor**  
Physics BSC Lab 1  
Physics Teacher's Room  
HOD Chamber  
Physics Lab 2  
Toilet  
Room  
Physics Classroom 3  
Physics Classroom 4

### "G" Block

**Second Floor**  
Physics BSC Lab 2  
Physics Teacher's Room  
Room  
Physics Lab 3  
Toilet  
Room  
Physics Classroom 5  
Physics Classroom 6

### "H" Block

#### Botany Department

**Ground Floor**  
Counselling Unit  
Library  
Office  
HOD Chamber  
Classroom 1  
Store Room 1

Classroom 2  
Kitchen  
Toilet  
Classroom 3  
Research Room  
Store Room 2  
Auditorium  
Lalit Kala Parishad

### "H" Block

#### Zoology Department

**First Floor**  
Zoology Lab UG  
HOD Chamber  
Zoology Specimen Area  
Zoology Lab PG  
Store Room  
Room  
Research Room  
Store Room  
Toilet  
Master's Special Room 1  
Master's Special Room 2  
Master's Special Room 3  
Hall  
Library  
HOD Chamber  
Smart Class  
Classroom  
Language Lab  
Terrace

### "I" Block

#### Commerce Department

**Ground Floor**  
BBA 1  
Toilet  
BBA 2  
BBA 3  
Toilet  
BBA 4  
Classroom/Examination Hall 1  
Classroom/Examination Hall 2  
Classroom/Examination Hall 3  
Classroom/Examination Hall 4

### "I" Block

**First Floor**  
BBA 5  
Toilet  
BBA 6  
BBA 7  
Toilet  
BBA 8  
Classroom/Examination Hall 5  
Classroom/Examination Hall 6

Classroom/Examination Hall 7  
Classroom/Examination Hall 8

### "J" Block

#### Geography Department

**Ground Floor**  
Classroom/Examination Hall 1  
Classroom/Examination Hall 2  
Classroom/Examination Hall 3  
Classroom/Examination Hall 4  
Room  
Geography Classroom 5  
Geography Classroom 6  
Geography Classroom 7  
HOD Geography Chamber

### "K" Block

#### Gurukul Building

**Ground Floor**  
Urdu Department  
History Department  
Pol. Science Department  
Toilet  
**First Floor**  
Hindi Department  
English Department  
Mathematics Department  
Economics Department  
Toilet

### "L" Block

**Ground Floor**  
PG Chemistry Extension  
& IGNOU Block

### "M" Block

**Ground Floor**  
Accounts Department  
Health Care

### Proposed Building

Proposed Humanities Block  
Proposed Garden  
Proposed Badminton Court  
Proposed Volleyball Court  
Proposed Pavilion  
Proposed Basket Ball  
Vermi-Compost PIT  
Rain Water Harvesting